

Cerniere

Hinges

Duschtübänder

Sistemi per box doccia tutto vetro con cerniere a scatto, cerniere libere, profili di battuta e a pavimento.

Frameless glass showers systems with clicking hinges, free hinges, door stop profiles and floor profiles.

Rahmenlosen Duschkabinensysteme aus Glas mit Selbstschließende Bänder, freie Bänder, Türanschlag Profile und Bodenprofile.





B-100

Cerniera a scatto vetro/muro.
Stop a 90° - Chiusura automatica da 10°.
Ottone forgiato.

Glass to wall hinge.
Stop at 90° - Auto closing up to 10°.
Forged brass.

Duschtürband Glas-Wand beidseitig 90°
öffnend selbstschließend ab 10°,
mit verstellbarer Nulllagenstellung,
Messing geschmiedet.

CR - NS

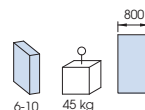
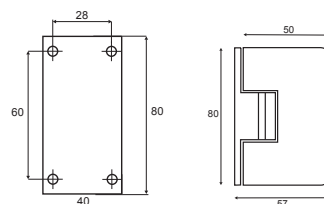
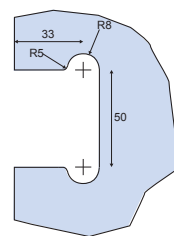
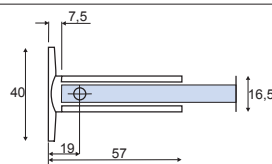

B-101

Cerniera a scatto vetro/muro ad aletta spostata.
Stop a 90° - Chiusura automatica da 10°.
Ottone forgiato.

Glass to wall hinge with offset base.
Stop at 90° - Auto closing up to 10°.
Forged brass.

Duschtürband mit einseitige Anschraubplatte
Glas-Wand beidseitig 90° öffnend
selbstschließend ab 10°, mit verstellbarer
Nulllagenstellung, Messing geschmiedet.

CR - NS

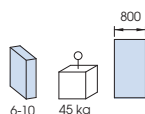
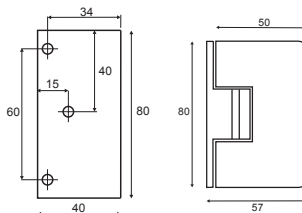
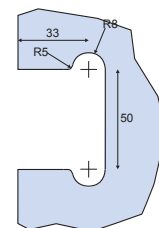
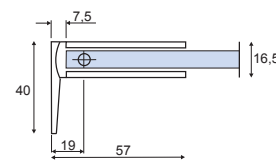

B-102

Cerniera a scatto regolabile vetro/vetro.
Stop a 0° +90° -90°.
Lavorazione del vetro standardizzata.
Ottone forgiato.

Adjustable glass to glass clicking hinge.
Stop at 0° +90° -90°.
Standard glass cut-out.
Forged brass.

Duschtürband Glas-Glas 180° beidseitig 90°
öffnend selbstschließend ab 10°,
mit verstellbarer Nulllagenstellung,
Messing geschmiedet.

CR - NS

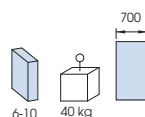
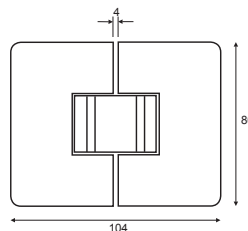
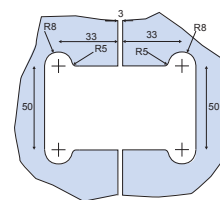
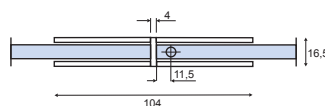

B-103

Cerniera a scatto regolabile vetro/vetro 90°
Stop a 0° +90° -90°.
Lavorazione del vetro standardizzata.
Ottone forgiato.

Adjustable 90° glass to glass clicking hinge.
Stop a 0° +90° -90° - Standard glass cut-out
Forged brass.

Duschtürband Glas-Glas 90° beidseitig 90°
öffnend selbstschließend ab 10°,
mit verstellbarer Nulllagenstellung,
Messing geschmiedet.

CR - NS

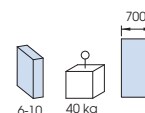
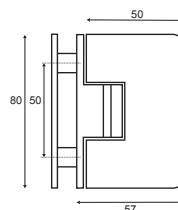
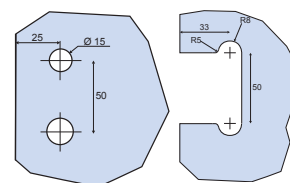
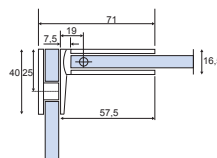

Cerniere

Hinges

Duschtübänder



B-105

Cerniera vetro/muro apertura a tirare.

Predisposta per guarnizione in PVC senza interruzione.

Glass to wall hinge, pull to open, fits continuous pvc seal.

Duschtürband Glas-Wand 90° nach außen öffnend.

CR - NS

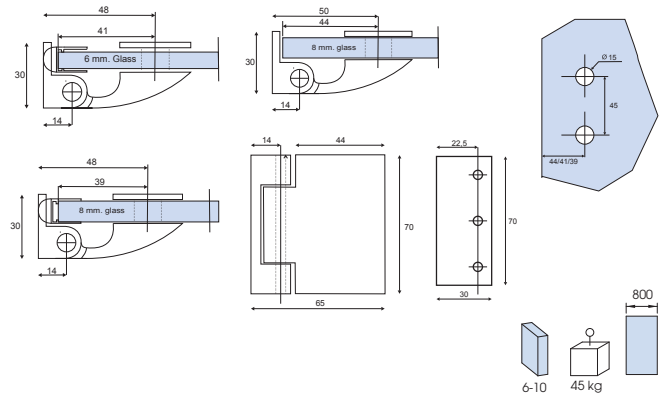

B-104

Cerniera vetro/vetro.

Predisposta per guarnizione in PVC senza interruzione.

Apertura solo di 90°.

Glass to glass hinge
Fits continuous PVC seals
opening outwards 90°.

Duschtürband Glas-Glas,
nach außen hin öffnend
90° die Dichtung muß nicht
unterbrochen werden.

CR - NS

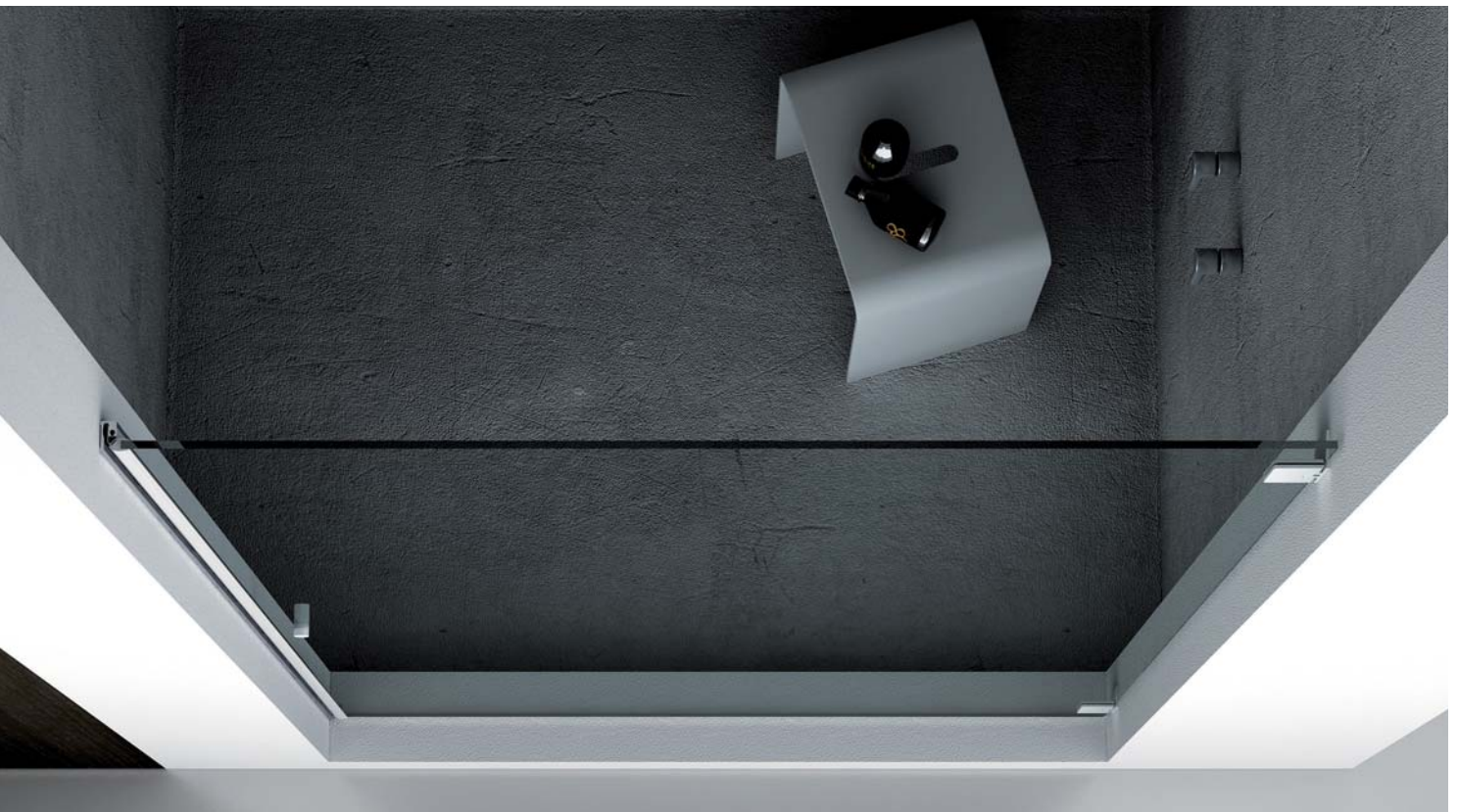
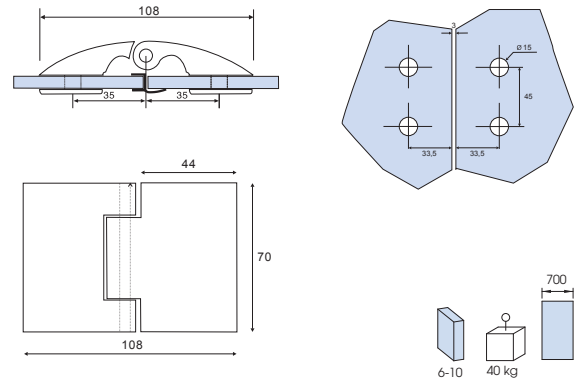



B-400

Cerniera a scatto vetro/muro.
Stop a 0° - Chiusura automatica da 10°.

Material: Zamak.
Glass to wall hinge.
Stop at 0° - Auto closing up to 10°.

Material: Zamak.
Duschtürband Glas-Wand stop 0°,
beidseitig öffnend selbstschließend ab 10°.

CR - NS

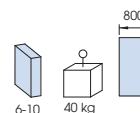
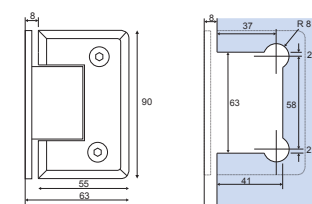
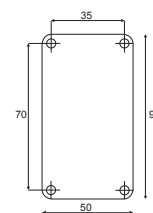
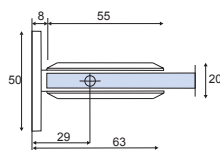

B-401

Cerniera a scatto vetro/muro ad aletta spostata.
Stop a 0°. Chiusura automatica da 10°.

Material: Zamak.
Glass to wall hinge with offset base.
Stop at 0°. Auto closing up to 10°.

Material: Zamak.
Duschtürband mit einseitige Anschraubplatte
Glas-Wand stop 0°,
beidseitig öffnend selbstschließend ab 10°.

CR - NS

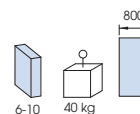
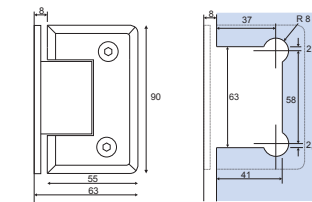
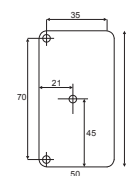
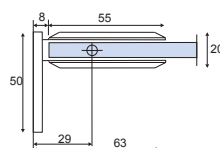

B-402

Cerniera a scatto vetro/vetro.
Stop a 0°.
Lavorazione del vetro standardizzata.

Material: Zamak.
Glass to glass clicking hinge.
Stop at 0°.
Standard glass cut-out.

Material: Zamak.
Duschtürband Glas-Glas 180° stop 90°,
beidseitig öffnend selbstschließend ab 10°.

CR - NS

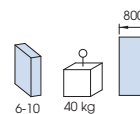
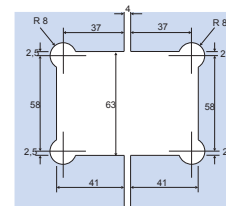
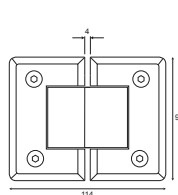
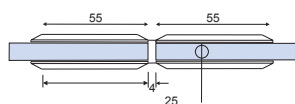

B-405

Cerniera a scatto vetro/vetro 90°.

Material: Zamak.
Glass to glass clicking hinge 90°.

Material: Zamak.
Duschtürband Glas-Glas 90°,
beidseitig öffnend.

CR - NS

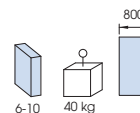
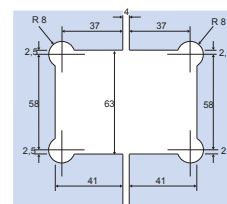
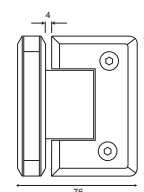
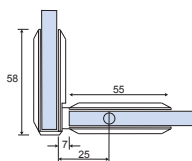

Cerniere

Hinges Duschtübänder

Alcune tipologie di applicazione
Some application typologies
Einigen kompositionsmöglichkeiten des
System

